

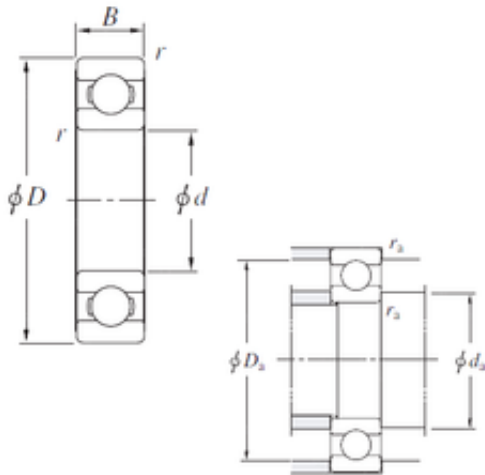

Machinery Parts Co., Ltd.



6972 KOYO Single-row deep groove ball bearings

Bearing No. 6972

6972 Bearing 2D drawings and 3D CAD models

Size	360x480x56 mm
Bore Diameter	360 mm
Outer Diameter	480 mm
Width	56 mm
d	360 mm
D	480 mm
B	56 mm
C	56 mm
r min.	3 mm
da min.	373 mm
Da max.	467 mm
ra max.	2,5 mm
Weight	28,2 Kg
Basic dynamic load rating (C)	289 kN
Basic static load rating (C0)	432 kN
(Grease) Lubrication Speed	1000 r/min
(Oil) Lubrication Speed	1200 r/min
Bearing No.	6972
r(min)	3
Cr	362
C0r	432
Cu	14.0
f0	16.5
Grease lub.	1000
Oil lub.	1200



Machinery Parts Co., Ltd.

da(min)	373
Da(max)	467
ra(max)	2.5
(Refer.)Mass(kg)	28.2