

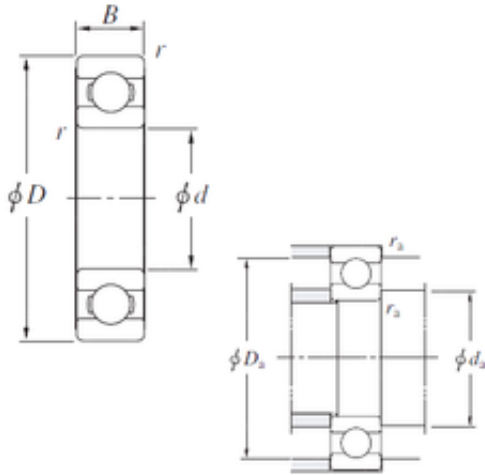

Machinery Parts Co., Ltd.



SB5034A Bearing 2D drawings and 3D CAD models

SB5034A KOYO Single-row deep groove ball bearings

Bearing No. SB5034A

Size	250x340x42 mm
Bore Diameter	250 mm
Outer Diameter	340 mm
Width	42 mm
d	250 mm
D	340 mm
B	42 mm
r min.	2,1 mm
da min.	261 mm
Da max.	329 mm
ra max.	2 mm
Weight	10,8 Kg
Basic dynamic load rating (C)	168 kN
Basic static load rating (C0)	202 kN