

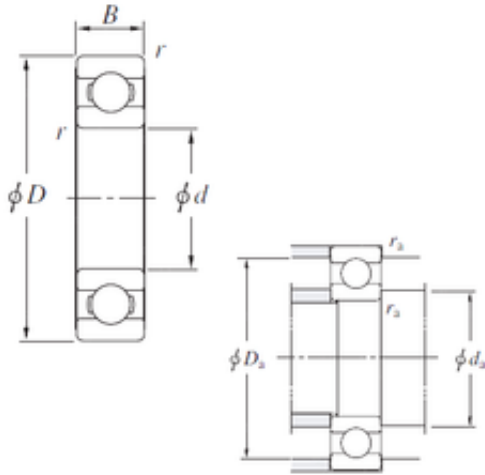

# Machinery Parts Co., Ltd.



6222 Bearing 2D drawings and 3D CAD models

## 6222 KOYO Single-row deep groove ball bearings

Bearing No. 6222

Size	110x200x38 mm
Bore Diameter	110 mm
Outer Diameter	200 mm
Width	38 mm
d	110 mm
D	200 mm
B	38 mm
C	38 mm
r min.	2,1 mm
da min.	121 mm
Da max.	189 mm
ra max.	2 mm
Weight	4,36 Kg
Basic dynamic load rating (C)	144 kN
Basic static load rating (C0)	117 kN
(Grease) Lubrication Speed	3100 r/min
(Oil) Lubrication Speed	3700 r/min
Category	Single Row Ball Bearings
Inventory	0.0
Manufacturer Name	KOYO
Minimum Buy Quantity	N/A
Weight / Kilogram	4.699
Product Group	B00308
Enclosure	Open
Precision Class	ABEC 1   ISO P0



## Machinery Parts Co., Ltd.

Maximum Capacity / Filling Slot	No
Rolling Element	Ball Bearing
Snap Ring	No
Internal Special Features	No
Cage Material	Steel
Internal Clearance	C0-Medium
Inch - Metric	Metric
Long Description	110MM Bore; 200MM Outside Diameter; 38MM Outer Race Diameter; Open; Ball Bearing; ABEC 1   ISO P0; No Filling Slot; No Snap Ring; No Internal Special Features
Category	Single Row Ball Bearing
UNSPSC	31171504
Harmonized Tariff Code	8482.10.50.68
Noun	Bearing
Keyword String	Ball
Manufacturer URL	<a href="http://www.koyousa.com">http://www.koyousa.com</a>
Manufacturer Item Number	6222
Weight / LBS	10.351
Outer Race Width	1.496 Inch   38 Millimeter
Outside Diameter	7.874 Inch   200 Millimeter
Bore	4.331 Inch   110 Millimeter
Bearing No.	6222
r(min)	2.1
Cr	180
C0r	117
Cu	6.20
f0	14.4
Grease lub.	3100
Oil lub.	3700



## Machinery Parts Co., Ltd.

da(min)	121
Da(max)	189
ra(max)	2
(Refer.)Mass(kg)	4.36